



HomeCam o-4G 4G MOTORISED SOLAR-POWERED STAND-ALONE WIFI IP CAMERA

EN

Ref.127162



AidsenHome

GET IT ON
Google Play

GET IT ON
App Store



A - SAFETY INSTRUCTIONS

1 - OPERATING PRECAUTIONS

- The camera must not be installed where the lens filter may be vulnerable to scratching and dirt.
- Do not expose the lens to direct sunlight or any reflected light source.
- Do not install near acidic chemicals, ammonia or sources of toxic gases.
- The installation and use of the camera must comply with local laws.
- Do not move the camera's motors by hand.

2 - MAINTENANCE AND CLEANING

- Always unplug the product before carrying out any maintenance.
- Never use abrasive or corrosive substances to clean the product.
- Use a soft, slightly damp cloth.
- Never use an aerosol to spray the product as this may damage the internal workings.

3 - RECYCLING



The disposal of used batteries in household waste is strictly forbidden. Batteries/accumulators containing harmful substances are marked with symbols (shown opposite) which indicate that it is forbidden to discard them in the household waste. The corresponding heavy metals are referred to as follows: Cd = cadmium, Hg = mercury, Pb = lead. You can dispose of these used batteries/accumulators at local waste facilities (centres for sorting recyclable materials), which are required to accept them. Keep batteries/button cells/accumulators out of reach of children and store them in a safe place not accessible to them. They could be swallowed by children or pets. Risk of death! In the event that a battery is swallowed, consult a doctor or go to A&E immediately. Never short-circuit the batteries, and do not burn or recharge them as they may explode!



This symbol means that devices no longer in use should not be disposed of with household waste. The hazardous substances they may contain can be harmful to health and the environment.  Return the equipment to your local distributor or use the recycling collection service provided by your local council.



Pour en savoir plus :
www.quefairedemesdechets.fr

1 - KIT CONTENTS

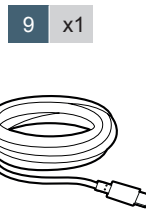
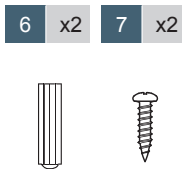
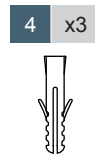
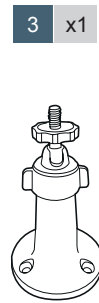
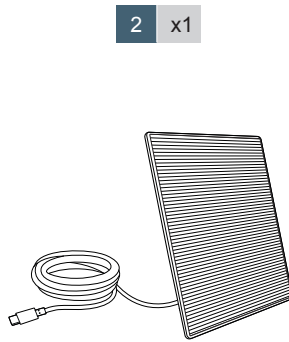
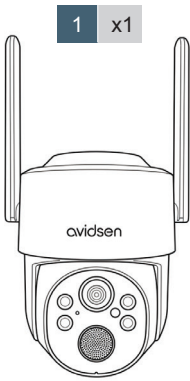

1	Camera
2	Solar panel
3	Bracket for attaching the solar panel
4	Wall plugs for attaching the panel
5	Screws for attaching the panel
6	Wall plugs for attaching the panel

7	Screws for attaching the panel
8	Camera Wall bracket
9	USB-C cable
10	Pre-loaded 300 MB SIM card

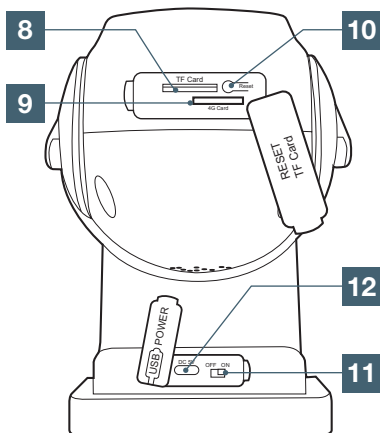
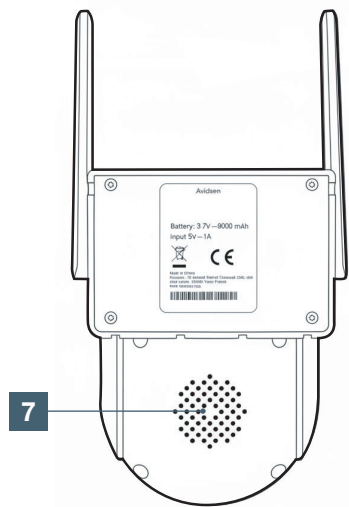
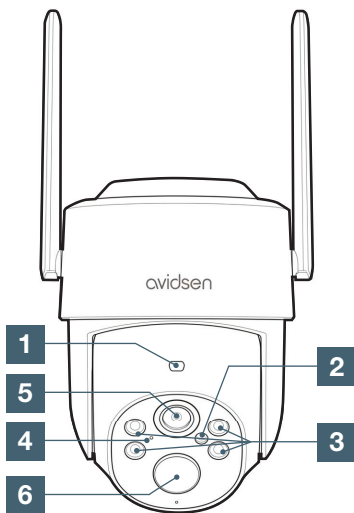

1	Microphone
2	Brightness sensor
3	Infrared light
4	Indicator light
5	Lens
6	Motion detector

7	Loudspeaker
8	SD card slot (SIM card not included)
9	Micro SIM card slot
10	Reset button
11	On/Off switch
12	USB-C socket

1 - OPERATION

This camera will allow you to monitor your home and will alert you directly on your smartphone if motion is detected. You can also make photo and video recordings with this device using a micro SD card (not included).

This camera works on **4G**. Good 4G coverage is therefore a prerequisite in the location where it will be installed. **A WiFi connection will not work with this camera.** It works with the SIM card supplied and is rechargeable. You can replace it with that of another phone provider. Although this camera is compatible with most phone providers, we cannot guarantee that it will work with all providers in Europe. We recommend conducting a test first with an identical SIM card to make sure 4G coverage is good in the area where the camera is to be installed.

If you use a SIM card other than the one supplied with the camera, you will need to disable the PIN code. A SIM card with a PIN code will not work. To find out more about this, please contact your phone provider

2 - INSTALLING THE CAMERA AND THE SOLAR PANEL

Secure the camera bracket at the desired height. Do not exceed a height of 2.50 m, as this would make motion detection uncertain.

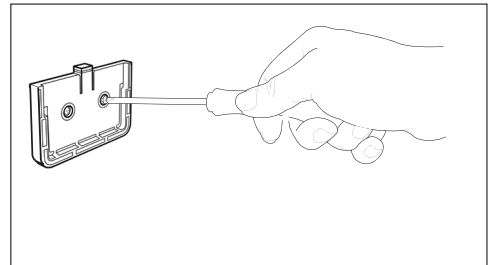
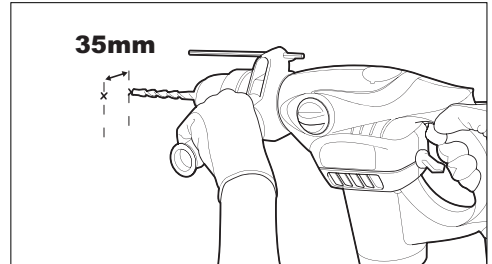
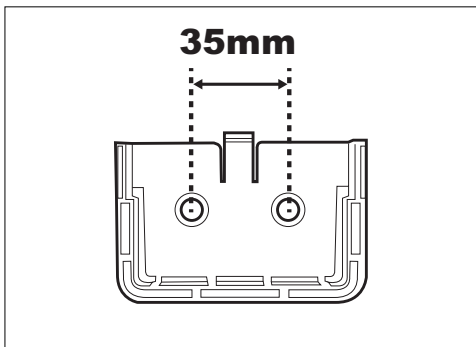

Slide the camera onto the bracket from top to bottom until you hear a **CLICK**.

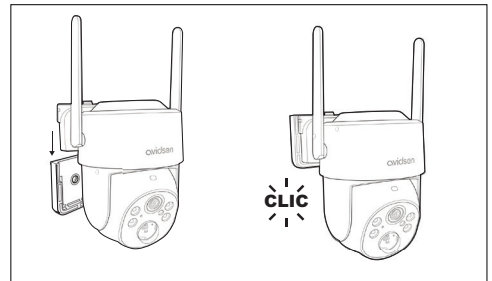

Attach the solar panel using the installed mounting holes. Check the distance between the panel and the camera before fixing it.

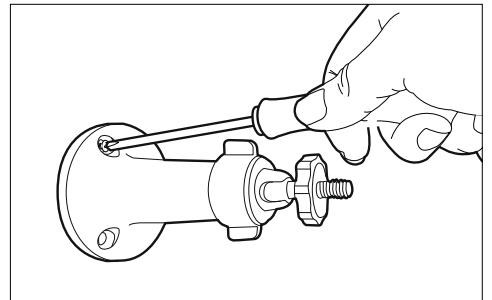

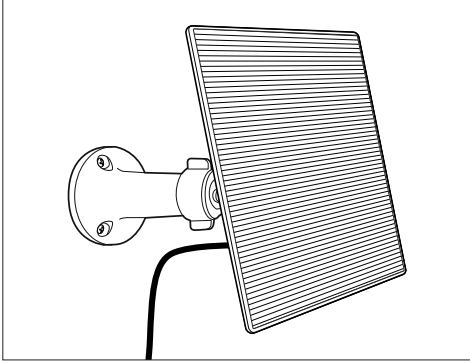

IMPORTANT: To ensure optimal charging of the solar panel, we recommend a south-facing position, tilted 30° upwards. Any other position will be less efficient and may render the charge insufficient if the camera is used a lot.

Connect the solar panel to the camera. Make sure that the camera cable passes through the seal on the camera.

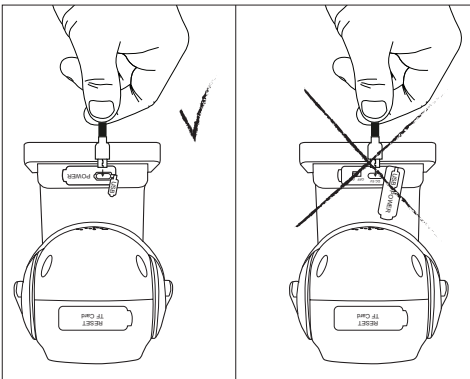
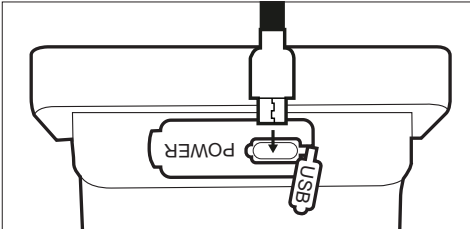

3 – SIM CARD OPERATION

The SIM card included with the camera comes pre-loaded with 300 MB of data and is **valid for 1 month**. After this period, you will need to recharge it to continue using the camera. The first free month starts when the camera is connected to the 4G network for the first time. Keep the SIM card holder in a safe place so that you don't have to take out the SIM card every time you top up.

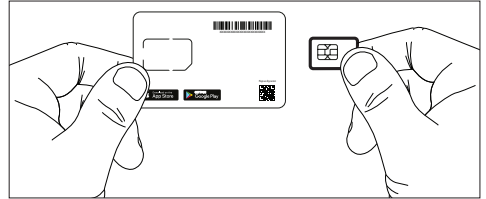

- 1- Scan the QR code.
- 2- Use the numbers in the boxes to access consumption and top-up.

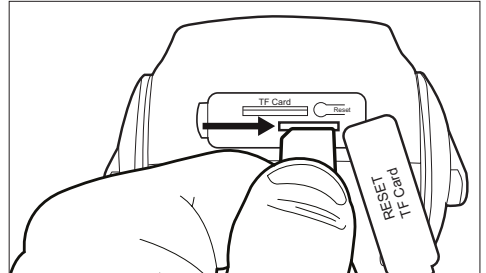

To access the SIM port, gently rotate the camera lens downwards. The SIM card format is nano SIM.

4 - INSTALLING THE MICRO SD CARD

To access the SD card port, gently rotate the camera lens downwards.

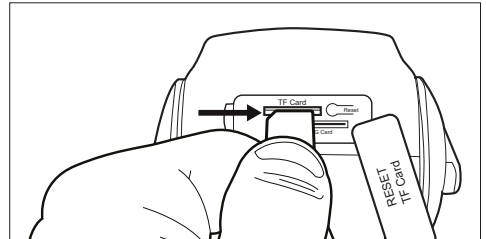

5 - INSTALLING THE MOBILE APP AND

CREATING AN ACCOUNT

Once the camera is connected, follow the instructions below to pair it. Download the AvidsenHome app from the Play Store or App Store.

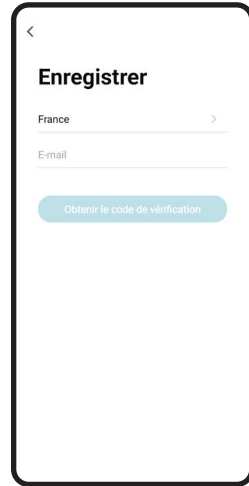

After accepting the privacy policy, you can create an account.

After entering your email address, tick **Valider l'inscription (Validate registration)** and then select **Obtenir le code de vérification (Get verification code)**.

Launch the app and log in if you already have an account. If not, press **ENREGISTRER (SIGN UP)** and let the application guide you.

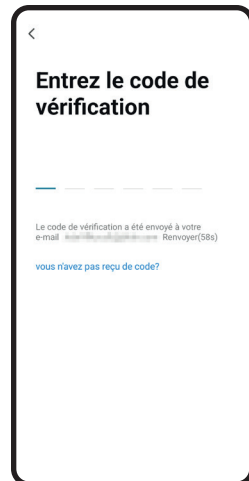
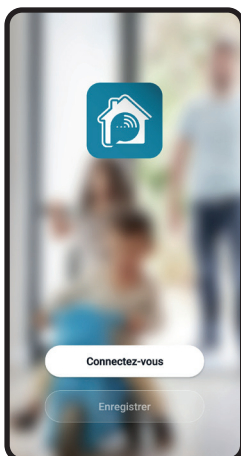

In a few seconds, you will receive a confirmation code in your email inbox. Enter this code to finalise registration.

Note that this email may go into your spam folder.

C - INSTALLATION

If you do not receive a code before the countdown has ended, press **Renvoyer** (Resend) and check the email address entered.

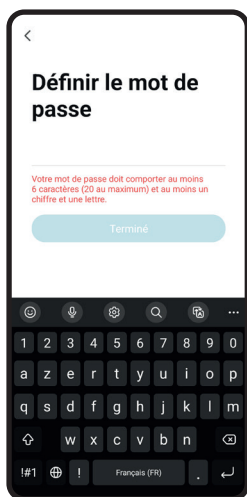

To complete your registration, set a password between 6 and 20 characters long with letters and numbers only, then press **Terminé (Finish)**.

6 – CONNECTING THE CAMERA

Note: If you have more than one item to pair (plugs, cameras, bulbs, etc.), switch on only one item at a time.

The following information may vary depending on app updates.

Toggle the On/Off switch to the **ON** position and wait. The camera will sound a beep confirming its correct start-up.

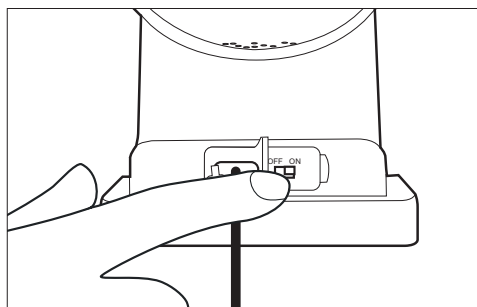

Before attempting to connect, make sure that the red light on the camera flashes quickly.

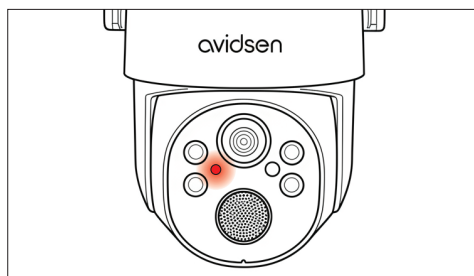

If this is not the case, please check that the **ON/OFF** switch is **ON** and press the **RESET** button on the camera for 10 seconds. If the red light does not flash, please charge the camera with the supplied cable and try again.

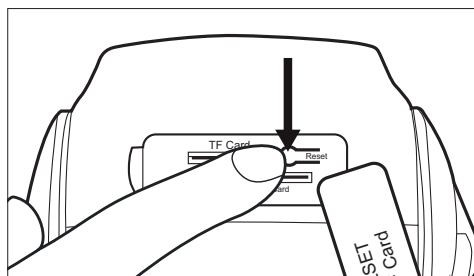

To start the installation, press **AJOUTER (ADD)**.

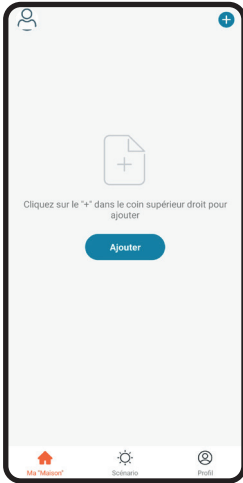

Select the product you wish to pair: **HomeCam o-4G** camera.

To speed up the display of the list during Bluetooth scanning, press once on your smartphone screen.

Make sure the ON OFF slider is set to ON and that the camera is powered up, then press **SUIVANT (NEXT)**.

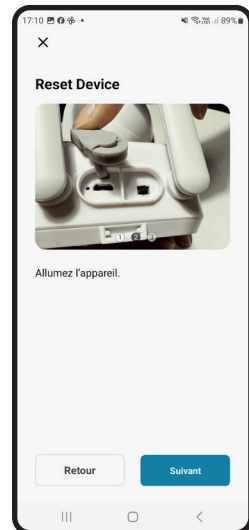

Make sure the SIM card is inserted correctly and press **SUIVANT (NEXT)**.

Make sure the blue indicator light is flashing to confirm that the camera is connected to the 4G network and press **SUIVANT (NEXT)**.



After pressing **Continuer (Continue)**, a QR code will be displayed on your screen. Place the screen of your smartphone **10-15 cm** in front of the camera lens, without moving the smartphone, until you get a reaction from the camera.

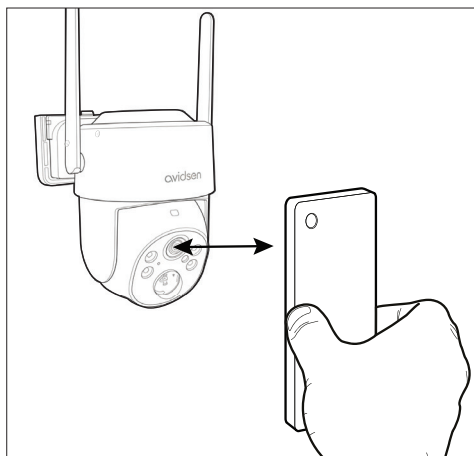

It will start to play a message indicating that it is connected to the 4G network. Next, press **J'ai entendu le bip (I heard the beep)**.

If this fails, check that the lens is clean and clear (protective film removed) and then repeat the step. Make sure your smartphone's screen is clean and in good condition, and turn up the brightness to the maximum.

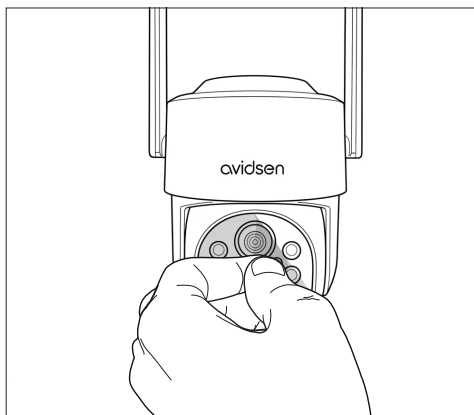

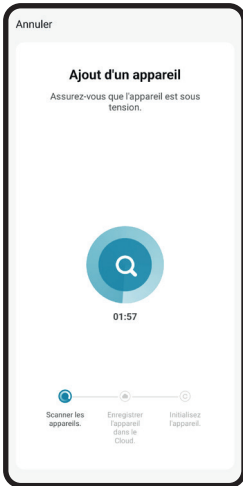

Please wait while the connection procedure takes place. This can take a few minutes.

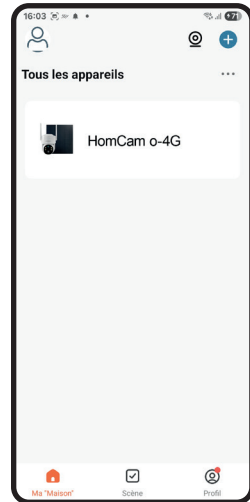

Your camera is now operational and appears in your app.

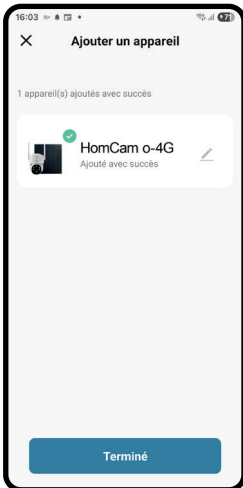

Your Avidsen **HomeCam o-4G** has been successfully paired. You can set a name by tapping the pencil and pressing **TERMINE (FINISH)**.

7- RESETTING THE CAMERA

The following instructions may help you if you have any problems during the pairing

procedure:

To **reset** the camera, press the **RESET** button for 15 seconds. The camera will emit a sound to confirm that the operation was successful. After a few seconds, the camera will emit a start-up sound. You can then start the procedure for putting the camera online.

Important: Please note that a reset does not delete the camera from the application.

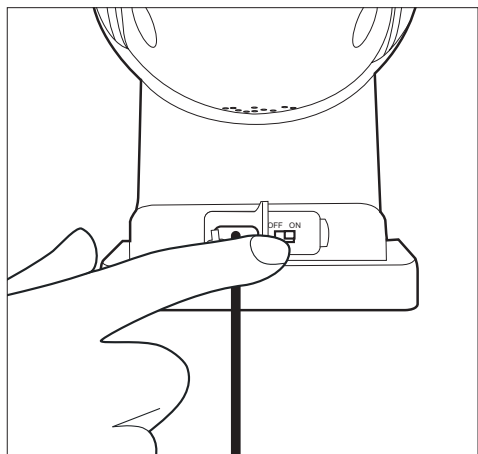

Deleting the camera from the application resets it. The camera will emit a sound a few seconds after deleting the camera from the application. To do this, tap the 3 dots at the top right of your screen. Once in **Paramètres (Settings)**, scroll down to the bottom of the interface and select **Enlevez l'appareil (Remove device)**.

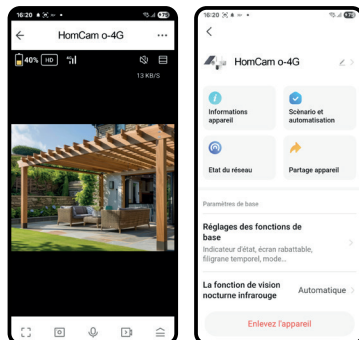

To complete the deletion process, press **Déconnecter l'appareil et vider les données (Disconnect device and dump data)**.

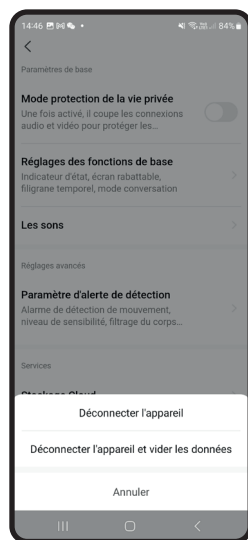

Your device has now been deleted from the app.

1 - USING THE HOMECAM O-4G CAMERA

With the **AvidsenHome** app, you can control several functions on the **HomeCam o-4G** camera, such as photo and video recording, motor control or even motion detection alerts.



1	Return icon
2	Device name
3	Device settings
4	Internet connection quality
5	Activate/Deactivate sound
6	GSM reception quality
7	Image quality adjustment
8	Camera battery charge
9	Full Screen
10	Take a photo
11	Activate/Deactivate oral communication
12	Activate/Deactivate video recording on the smartphone's internal memory
13	Show/hide the menu
14	Video recording playback interface
15	Access photo album
16	Dark/light mode
17	Activate/deactivate infrared night vision
18	Adjusts the image frequency to prevent flicker
19	Activate/Deactivate motion detection notification
20	Activate/deactivate motion sensor
21	Manually activate/deactivate the siren
22	Manually activate/deactivate the light
23	Not used
24	Allows you to customise the feature display icons
25	Message history
26	Motor control (you can also slide your finger over the camera image to position it)
27	Features menu

D - USING THE PRODUCT

1.1 RECORDING WITHOUT MICRO SD CARD

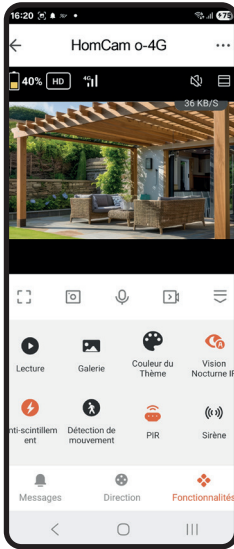

You can take a screenshot or make a manual recording without a micro SD card, and these elements will be stored directly in the memory of the smartphone that made the recording. They can then be viewed directly in the **Galerie** (Photo Album) tab.

Click on  to take a screenshot

Click on  to make a video recording

Important: it is not possible to create a recording or event recording without a micro SD card.

1.2 RECORDING WITH AN SD CARD

A micro SD card is required if you wish to create a continuous recording.

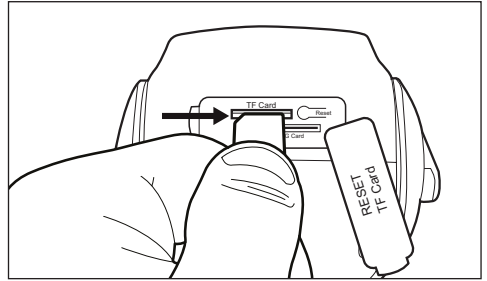

Insert the micro SD card into the camera, then go to the **Réglages de la carte SD** (SD card settings) menu. Click on **Formatage de la carte SD** (Format SD card) to initialise the micro SD card.

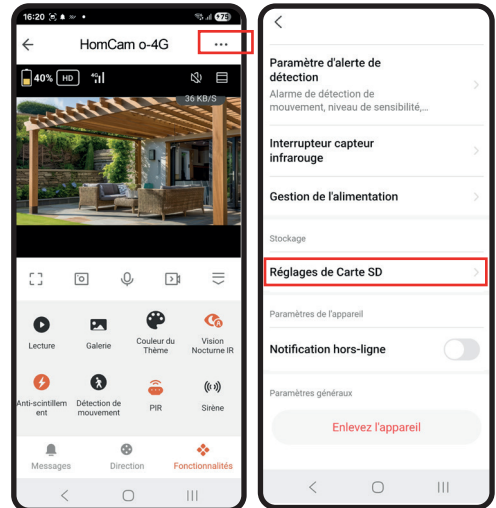

If motion is detected, a recording will automatically be made on the micro SD card. This camera does not allow continuous recording.

1.3 ACTIVATING MOTION DETECTION

The camera can also record automatically in the

event of movement. The camera will record for 15 seconds (non-adjustable). Please activate the function in the camera settings.

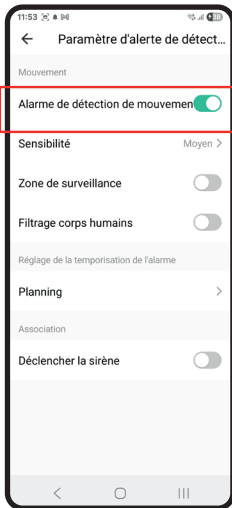

1	Activate/Deactivate motion detection alerts
2	Detection sensitivity setting Low/Medium/High: • In the event of unwanted detection, reduce sensitivity • If no motion is detected, increase sensitivity
3	Create a hidden area to ignore a detection zone. (The red zone is the detection zone)
4	Limits detection to human figures (or similar)
5	Trigger the alert siren if motion is detected

2 - VIEWING RECORDINGS

You can view the photos and the videos saved on the micro SD card from the **Messages** menu, then click on **Tout** (All).

Note: photos and videos cannot be viewed from a computer.

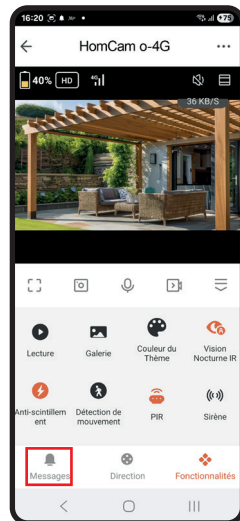

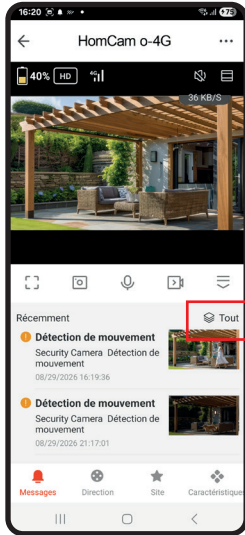

All photo and video recordings based on motion detection will be present:

2.1 Using Photos from your smartphone

By clicking on the photo, you can use or share the picture taken by the camera.

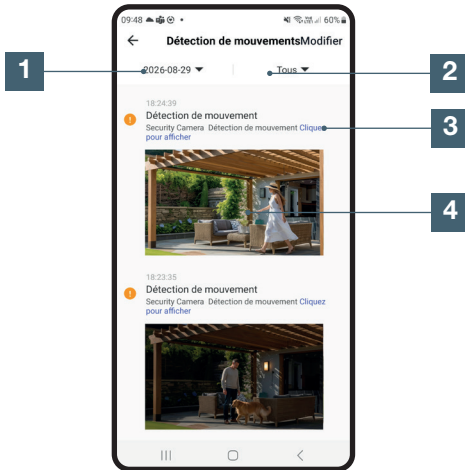

- | | |
|---|---|
| 1 | Select the day of detection |
| 2 | Filter the type of alert |
| 3 | Click on "Cliquez pour afficher" (Click to view) to watch the video |
| 4 | Click on the photo to enlarge and use the screenshots. |



- | | |
|---|---|
| 1 | Save the picture to the smartphone's memory; it will be accessible in the smartphone's album. |
| 2 | Delete the video |
| 3 | Share the photo by email or the network of your choice |

2.2 Using videos from your smartphone

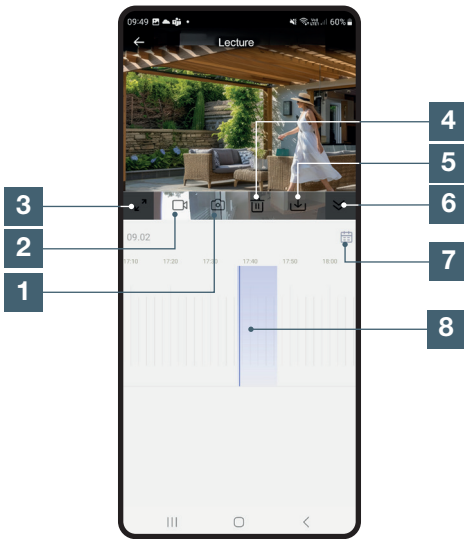

1	Save a photo to the smartphone's memory; it will be accessible in the smartphone's Album
2	Save the video you are watching live to the smartphone's memory; it will be accessible in the smartphone's Album
3	Set the video to landscape mode
4	Delete all videos taken during the selected day
5	Download a video to your smartphone at a set time
6	Reduce the size of the time slot
7	Choose the day of detection
8	Select the time slot by dragging the central blue cursor. White zones indicate no detection. Light blue zones indicate recordings made.

3 - OTHER SETTINGS



1	Change icon, camera name and room for the AvidsenHome application
2	Technical information
3	Integrate the camera into AvidsenHome scenarios
4	Menu to share AvidsenHome account access
5	Activate the operation indicator, invert the image, activate two-way audio and correct flicker issues
6	Activate or deactivate infrared vision
7	Set motion detection alerts
8	Adjust the sensitivity of the PIR sensor
9	Show the battery charge status
10	Check the size and format of the micro SD card (this menu only appears when a micro SD card is inserted in the camera)
11	Receive a notification in the event of the camera being disconnected from the Internet
12	Frequently asked questions
13	Put a shortcut on the home screen of your smartphone to access the camera
14	Check camera update.

4 - BENEFIT AND USE OF PARTS IN THE AVIDSEN HOME APPLICATION

With the **AvidsenHome** application, you can manage different kinds of smart devices (bulb, smart plug, camera) which can be linked to a specific room in your home, for creating scenarios or organising your devices in the application. To do this, it is necessary to create a “family”.

4.1 CREATING A FAMILY

Tap the profile icon at the bottom right to access the profile settings.



Then select **GESTION DE LA FAMILLE** (FAMILY MANAGEMENT). You can then choose a house name (required), its location (optional) and the rooms in the home.

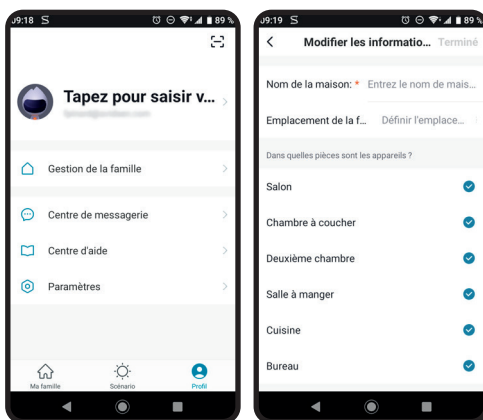

Once your family has been configured to your liking, click on “**Terminé**” (Finish) at the top right. The family name (“house” in this example) will then appear on the home screen with your devices.

5.1 TRIGGERING A SET OF ACTIONS (SCENARIO)

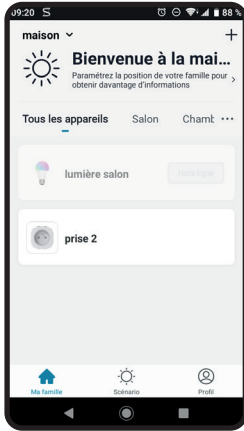

You can then set the location of a device by going to its settings and choosing the position of the device in the home. The smart device will now appear in the selected room.

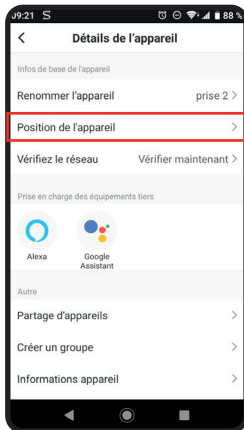

5 - SCENARIO AND AUTOMATION

Each device in the **AvidsenHome** range can be triggered and interact with other products. This way, you can create life scenarios, grouping different actions or sequences into one, or automatically trigger a device according to the status of another.

The scenario system in the **Avidsen Home** app allows you to group actions that will be triggered on demand, by clicking on a single button on your smartphone.

Example: creating an “I’m going” scenario to turn off my smart plug and activate motion detection on my camera:

Click on  at the bottom of the screen, then on **Scénario** (Scenario) at the top left and, finally, on **Ajouter un scénario** (Add a scenario):



Name your scenario, then click on  to set the actions to be executed:

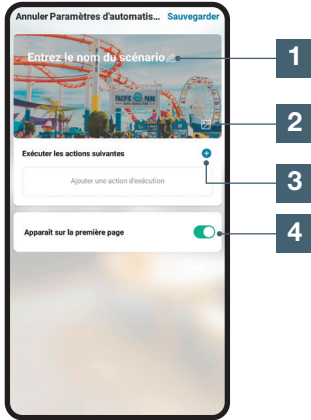

1	Allows you to use a previously defined automation (an automatic action). See next paragraph for more details
2	Allows you to insert a pause of an adjustable time period in the performance of actions
3	Displays the list of products already linked in the app and the possible actions

The **Choisissez votre automatisation** (Choose your automation) function allows you to call on an automation that has already been saved and enable or disable it while the new scenario is running.

5.1.1 PROGRAMMING THE "I'M GOING" SCENARIO

The scenario in this example will allow the user to activate motion detection on their camera and turn off a smart plug just by clicking on a single icon in the app.

After following the previous steps, click on **"Appareil"** (Device) to access the list of possible actions for each device that you wish to trigger with your scenario. In this example, Avidsen HomePlug is selected.

1	Name your scenario here at your convenience
2	You can change the background image here
3	Set the actions to be performed by clicking here
4	If the box is checked, the scenario will be displayed alongside your products linked to the app

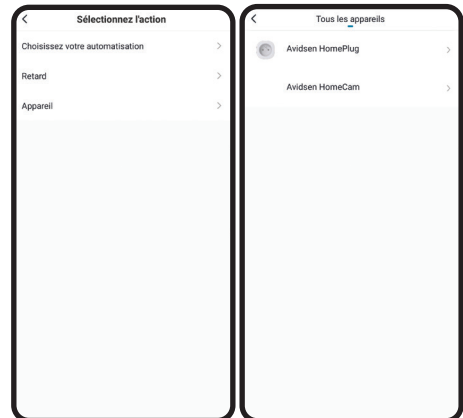
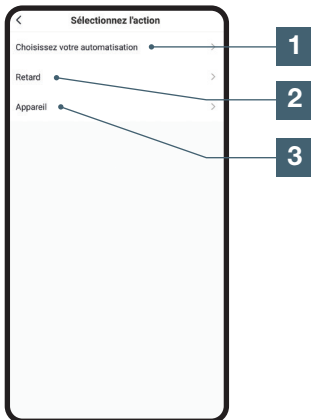

Then define each of the actions to be performed (in our example: select **Commuter** (Switch) then **Arrêt** (Stop). To finish, press **Sauvegarder** (Save) then **Suivant** (Next).

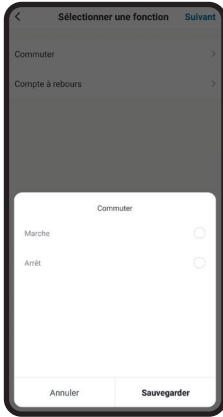

Repeat the step, selecting the HomeCam this time, then **Motion Alert** and **On**. To finish, press **Sauvegarder** (Save) then **Suivant** (Next).

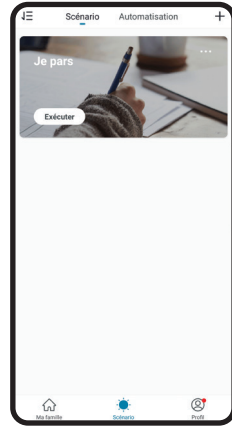

If you wish to access the details or delete it, click on the "..." icon at the top right of its name.

The scenario you have just created will appear on the list on the **Scénario** (Scenario) tab of the app.

If you checked the "Apparaît sur la première page" (Display on the first page) box, the scenario created will also appear alongside your products on the **Ma famille** (My family) screen.

Just click on the **Exécuter** (Execute) button to launch the entire sequence that you have programmed in your scenario.

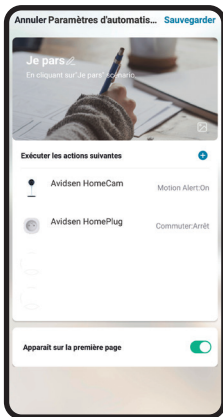

The actions for the camera and the plug will then appear in the scenario list. You will then have to press **Sauvegarder** (Save) at the top right to complete the scenario.

5.2 - CREATING AN AUTOMATION

The automation system in the **Avidsen Home** app allows you to group devices and actions which will be triggered automatically by the action of another device or a condition (temperature, time, etc.).

Example: creating a "Living room lighting" automatic action that turns on the light for a few seconds when a movement is detected by the camera:

Click on  and then on **Automatisation** (Automation) at the top right and finally on **Ajouter une action automatique** (Add automatic action):

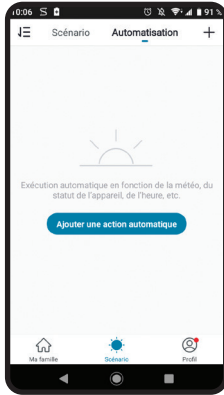

One of the most important settings is the selection of the **type de condition** (condition type). This allows automation to deal with multiple conditions.

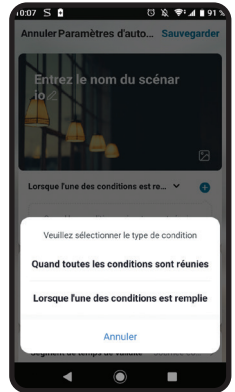
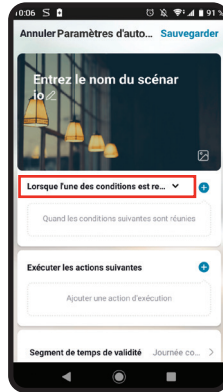

- **Quand toutes les conditions sont réunies** (When all the conditions are met) corresponds with an "ET" (AND) function:
 - If Temperature = x **ET** (AND) time = y **ET** (AND) device = n then...
- **Lorsque l'une des conditions est remplie** (When one of the conditions is met) corresponds with a "OU" (OR) function:
 - If Temperature = x **OU** (OR) time = y **OU** (OR) device = n then...

After selecting the condition type, choose the conditions themselves:

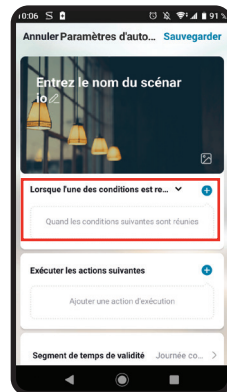

1	Go back
2	Save automation
3	Change the name as you wish
4	You can change the background image if you wish
5	Selection of condition type
6	Selection of conditions to be met for actions to be executed
7	Selection of actions to be executed
8	Selection of the automation validity time slot (e.g. only at night)



1	Set a temperature weather condition*
2	Set a humidity weather condition*
3	Set a weather condition*
4	Set a sunrise or sunset condition*
5	Set a wind condition*
6	Set a time condition
7	Set a condition from a device already linked to the app

*These conditions take into account the geolocation of your smartphone to access weather data.

The following part is related to the actions that will be triggered by the conditions:

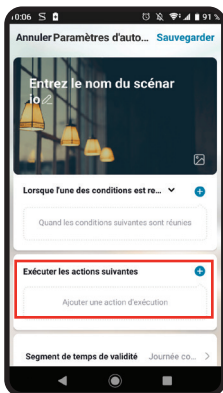

1	Allows you to use a previously defined Scenario (set of actions).
2	Allows you to use a previously defined automation (an automatic action)
3	Allows you to send a notification to the smartphone when automation is active
4	Allows you to insert a pause of an adjustable time period in the performance of actions
5	Set an action on a device already recorded in the app

The last setting allows you to define a time slot during the day, if necessary, during which to authorise the automation launch:

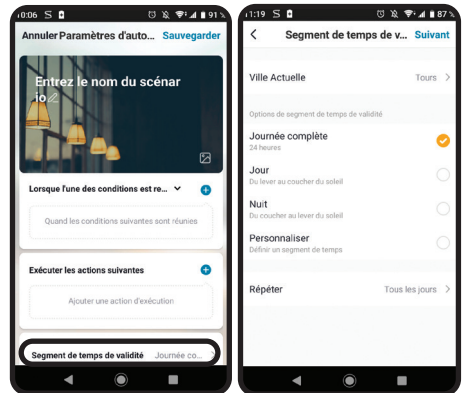

D - USING THE PRODUCT

Once all these settings have been confirmed, you can save your automation at the top right

one motion detection condition and another for the lamp to be off.

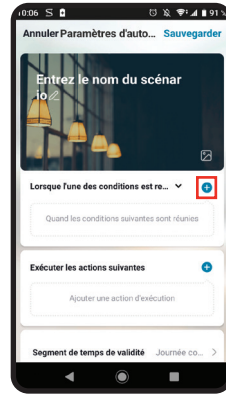
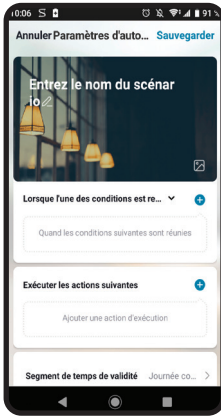

5.2.1 PROGRAMMING THE “LIVING ROOM LIGHTING” AUTOMATION

The automatic action in this example will allow the user to turn on the bulb at night as soon as motion is detected by the camera and the lamp is already off. After a minute, the lamp will turn off until the next detection.

First, select the condition type. In this example, all of our conditions must be active to turn the bulb on. So select **quand toutes les conditions sont réunies** (when all the conditions are met).

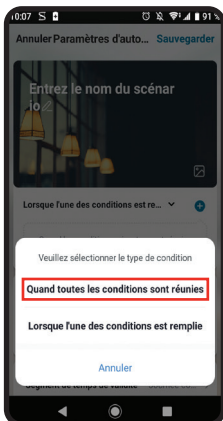

Then select the conditions. In our case, we need

• FOR THE CAMERA

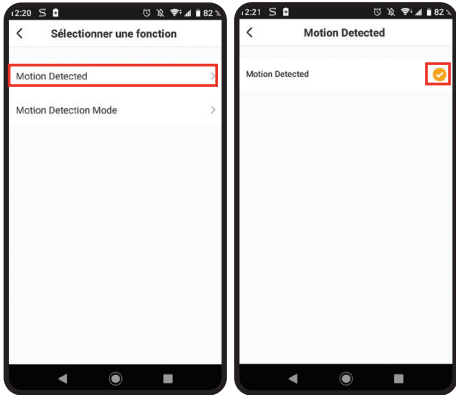
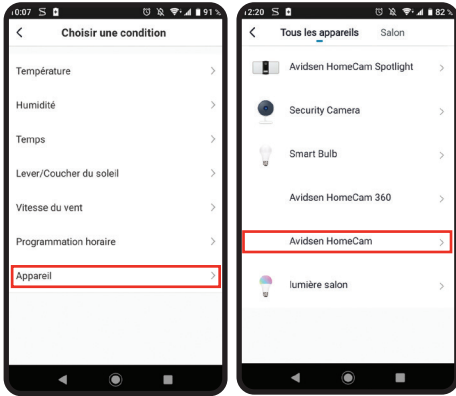

• FOR THE BULB

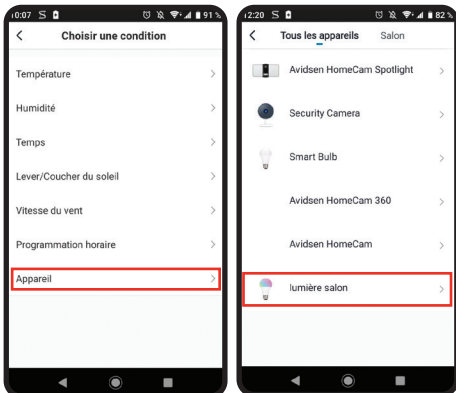

Under these conditions, the actions will start if motion is detected in the camera's visual field **ET** (AND) if the bulb is off:

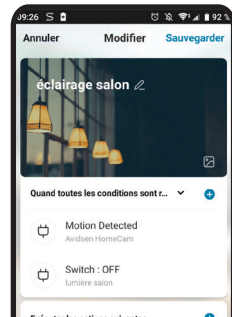

Now, set the actions that will be carried out:

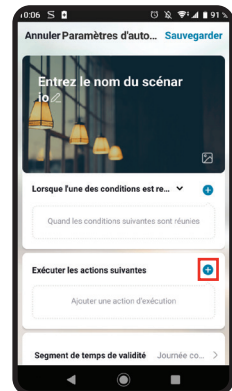

D - USING THE PRODUCT

To turn on the bulb:

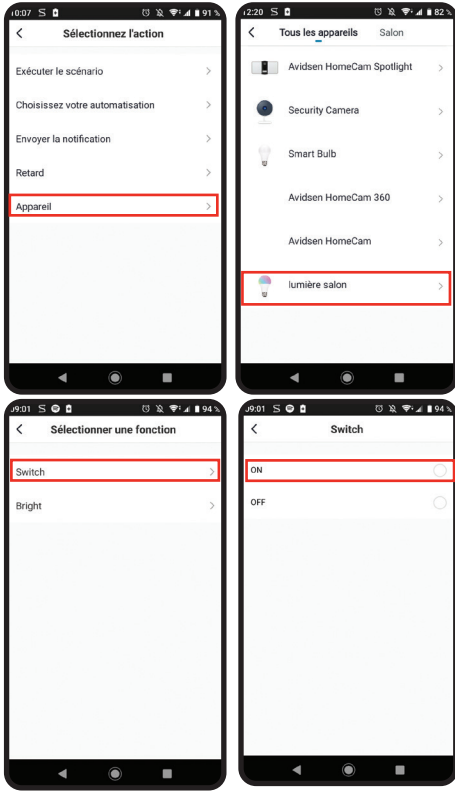

Then add a “retard” (delay) that will trigger the next action after the desired time period:

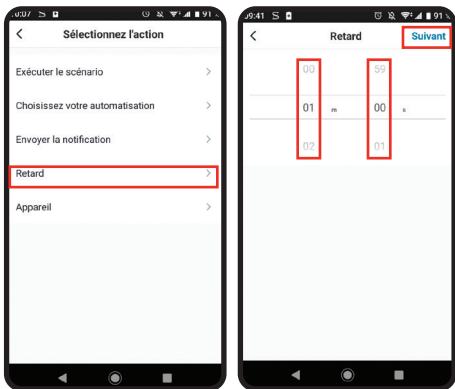

Then add the last action, turn off the lamp in this example:

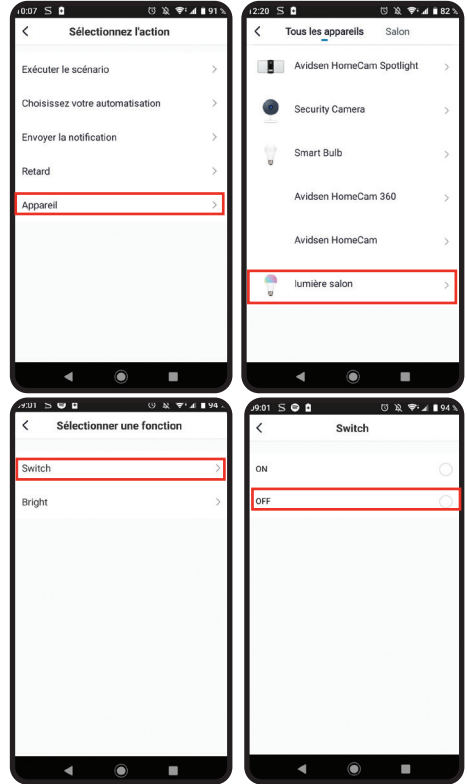

After these steps, you will have 3 actions: turn on the bulb, wait one minute and turn off the bulb:

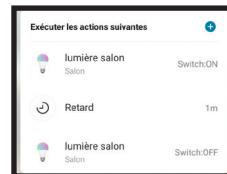

Finally, you can choose an automation validity period, in this case at night:

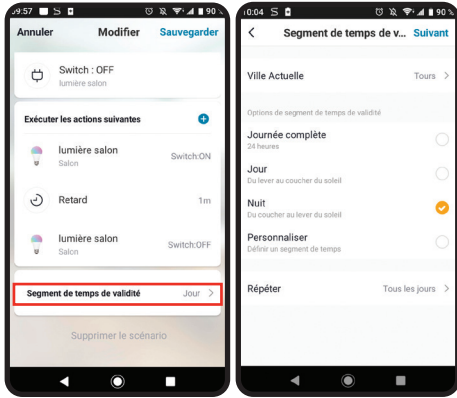

The automation is now complete. You can save it at the top right:

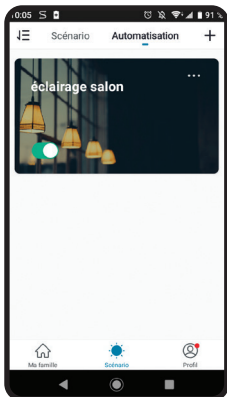
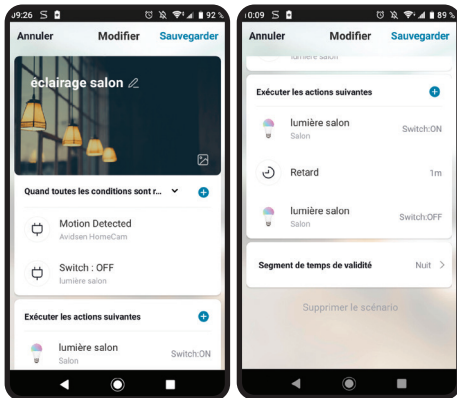

If you wish to access the details or delete it, click on the "..." icon at the top right of its name.

E - FAQ

Symptoms	Possible causes	Solutions
<i>Unable to install the Avidsen Home app on my Android device</i>	You have an out-of-date or incompatible version of Android on your device.	Please contact the technical support of your device's manufacturer in order to obtain a recent Android version.
	GooglePlay checks all the key components needed to run the application properly. If your equipment does not meet the necessary criteria, the installation will not complete	Try the installation on a different Android device.
<i>Unable to install the Avidsen Home app on my Apple device</i>	The version of iOS on your device is not up to date.	Update the operating system on your device.
	Your device is not supported.	Avidsen Home is compatible from version IOS 10.
<i>The app freezes or there are bugs.</i>	You experience problems configuring the app or accessing your camera(s).	Please uninstall the app and reset your camera(s). To complete the installation, please add your camera(s)
<i>Cannot connect to camera over a 4G Internet link but it works when connected to a local network</i>	Network configuration problem	Check your device settings.
	Incorrect video settings	Check the video settings and reduce the quality if necessary.
	Your home Internet speed is insufficient to support the connection from your smartphone	Check that the available bandwidth exceeds 1 Mbits per second (upload and download) for low-quality display; or that it exceeds 2 Mbits per second for HD
<i>Poor quality or shaky image</i>	Incorrect video settings	Check the video settings and reduce/increase the quality if necessary.
<i>Motion detection is triggered unnecessarily</i>	Unsuitable motion detection settings	Reduce the sensitivity of detection.

<p><i>When motion is detected, no Push alert is received.</i></p>	<p>Unsuitable motion detection settings</p>	<p>Please check the configuration of the camera, the enabled alerts and the motion sensitivity.</p>
	<p>The application is not authorised to send push notifications</p>	<p>Please check your Avidsen Home rights within your iOS application Security and Privacy settings or Android application settings.</p>
<p><i>Push Notifications only work when the app is displayed on the Android screen</i></p>	<p>Avidsen Home is not allowed to run in the background, or has been completely closed.</p>	<p>Please restart Avidsen Home. Make sure that no other management or power saving application automatically closes the application in the background.</p>
	<p>Your Android device has reached the maximum limit of applications that can be launched simultaneously</p>	<p>Close the applications or increase the limit of simultaneous applications in your device settings.</p>

CAMERA LED STATUS

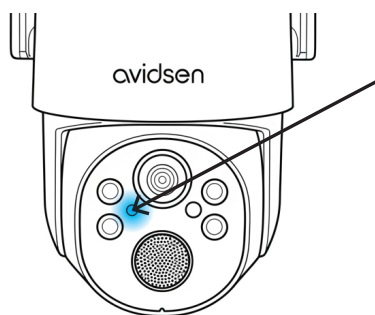

<p><i>Steady blue light</i></p>	<p>Camera being viewed</p>
<p><i>Flashing blue light</i></p>	<p>Loss of 4G or camera connection during connection</p>
<p><i>Flashing red light</i></p>	<p>Waiting for connection</p>
<p><i>Led off</i></p>	<p>Camera in standby or camera not powered</p>

1 - TECHNICAL CHARACTERISTICS

Resolution	2.5k / 3MP
Technical features	Power supply: 5200 mAh lithium battery supplied; 5V 3W solar panel to charge Communication protocol: 4G (frequency band B1/3/5/7/8/20/28)
Audio	Two-way
Night vision	Yes, 8 m range
Sensor and lens	1/2.9" CMOS Viewing angle 80°
Shutter speed and compression	1/25 – 1/100,000 per second - H264
Rotation angle	Vertical: 135° Horizontal: 355°
Storage	Yes, on microSD card (128 GB max, not included)
Battery life	Without charging: 3 months, depending on use. The connection to the camera is USB-C: it can be charged with a 5 V mains adapter (not included) if you do not wish to use the solar panel. With solar panel: permanent
Operating temperature	-10°C +55°C
Protection rating	IP44
Dimensions	- Camera: 130 mm x 140 mm x 105 mm - Solar panel: 174 mm x 120 mm x 15 mm - Cable length (included) between panel and camera: 2.5 m

2 - WARRANTY

- This product is guaranteed for parts and labour for 3 years from the date of purchase. Proof of purchase must be retained for the duration of the warranty period.
- The warranty does not cover damage caused by negligence, knocks or accidents. The parts of this product must not be opened or repaired by any persons not employed by Avidsen. The warranty will be void if the device is tampered with.
- Avidsen undertakes to keep a stock of spare parts for this product throughout the contractual warranty period.



If you have any problems, check out our tutorials and videos at:
www.avidsen.com/fr/assistance/tutoriel-sav

3 - EU REGULATION 2023/2854E

Use of data in accordance with REGULATION (EU) 2023/2854		
Type	Audio/video, images, motion detection events, connection status, device configuration	
Format	Collected in JSON format; stored in MySQL tables; exported in XLS format	
Volume	~50MB (depends on bit rate and reporting frequency)	
Is data generated	Continuously (with latency time)	/
	In real time	Only during a user operation or automatic triggers
Where is the data stored	Europe	
Data retention period	1.Real-time activity logs: pseudonymised after 7 days, stored for a maximum of 12 months. 2. Account-level data: stored until the user deletes the account	
How to	Access data	1.in the application: review the app's privacy policy 2. Web: submit a request to https://www.avidсен.com
	Extract data	
	Delete data	We do not sell, rent or disclose personal data to third parties. Any sharing only takes place with the explicit consent of the user. To find out more: read the privacy policy.
	Share data	
Stop sharing	1.in the application: review the app's privacy policy 2. Web: submit a request to https://www.avidсен.com	
Data subject's identity (contact details)	https://www.avidсен.com Address: 19 avenue Marcel Dassault -37200 Tours- FRANCE Contact: hotline@avidсен.com	



F - TECHNICAL AND LEGAL INFORMATION

4 - EU DECLARATION OF CONFORMITY

Avidsen declares, under its sole responsibility, that the equipment with reference number 114162 complies with the applicable Union harmonisation legislation and its conformity has been assessed pursuant to the applicable standards in force:

- RED Directive 2014/53/EU

EN 301 489-1 V2.2.3

EN 301 489-3 V2.3.2

EN 18031-1: 2024

EN 18031-2: 2024

- LVD Directive 2014/35/EU

EN 62368-1 :2020+A11 :2020

EN 62311:2020

- EMC Directive 2014/30/EU

EN 55032 :2015+A11 :2020

EN 55035 :2017+A11 :2020

- ERP Directive (EU) 2023/826

RoHS Directive 2011/65/EU and Delegated Directive 2015/867/EU.

REACH Directive 1907/2006/EU

Directive 2023/826/EU

Signed by Alexandre Chaverot,

CEO, on behalf of Avidsen 19 avenue Marcel Dassault, 37200 Tours, France

Tours, 30/03/2026





aidsen

Aidsen
19 avenue Marcel Dassault - ZAC des Deux Lions
37200 Tours - France
www.aidsen.com