



Small Doorguard

MINI DOOR/WINDOW ALARM

Includes a door opening detector with built-in siren

Ref. 100023

EN



WIRELESS



FOR DOORS
AND WINDOWS



120 dB
BUILT-IN
SIREN



BATTERY
OPERATED



FREQUENCY
433 MHz

A - SAFETY INSTRUCTIONS

1 - OPERATING PRECAUTIONS

- Do not allow children to handle the product.
- Do not place liquids or water containers on top of the device.
- Do not install near acidic chemicals, ammonia or sources of toxic gases.
- Do not install the product outdoors, on unstable surfaces or near equipment that emits magnetic fields.
- Do not install in locations that are subject to extreme temperatures.
- For indoor use only

2 - MAINTENANCE AND CLEANING

- Always turn off the product using the ON/OFF switch on the side of the product before carrying out any maintenance (On: switch up / Off: switch down).
- Never use abrasive or corrosive substances to clean the product.
- Use a soft, slightly damp cloth.
- Never use an aerosol to spray the product as this may damage the internal workings.

3 - RECYCLING



The disposal of used batteries in household waste is strictly forbidden. Batteries/accumulators containing harmful substances are marked with symbols (shown opposite) which indicate that it is forbidden to discard them in the household waste. The corresponding heavy metals are referred to as follows: Cd = cadmium, Hg = mercury, Pb = lead. You can dispose of these used batteries/accumulators at local waste facilities (centres for sorting recyclable materials), which are required to accept them. Keep batteries/button cells/accumulators out of reach of children and store them in a safe place not accessible to them. They could be swallowed by children or pets. Risk of death! In the event that a battery is swallowed, consult a doctor or go to A&E immediately. Never short-circuit the batteries, and do not burn or recharge them as they may explode!



This symbol means that devices no longer in use should not be disposed of with household waste. The hazardous substances they may contain can be harmful to health and the environment. Return the equipment to your local distributor or use the recycling collection service provided by your local council.



Pour en savoir plus :
www.quefairedemesdechets.fr

1 - KIT CONTENTS

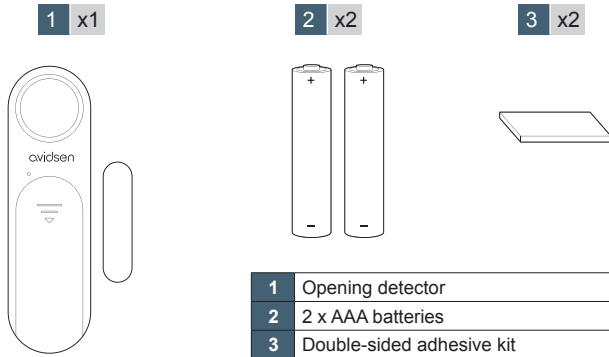

1	Opening detector
2	2 x AAA batteries
3	Double-sided adhesive kit

2 - DOOR OPENING DETECTOR

- When armed, the mini-alarm is triggered immediately when the door is opened.
- Low standby consumption <150uA
- Low battery reminder

3 - OPERATING INSTRUCTIONS

3.1 - POWER ON/OFF

Install the 2 AAA batteries in the product and push the switch up to "ON"; the device will **beep** twice and the red LED will flash twice to indicate that the device is switched on. To switch off the device, push the switch down to "OFF".

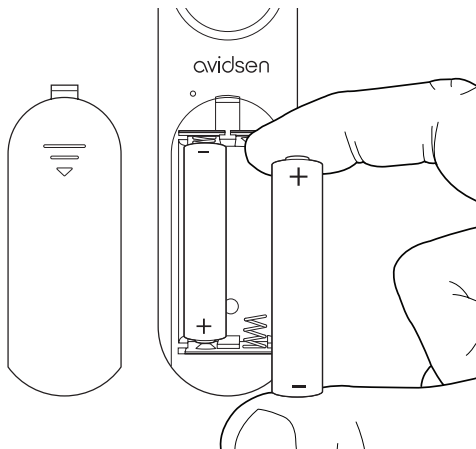

3.2 - ARMING/DISARMING

Briefly press the [SET] button on the device to switch from armed to disarmed state. The red light on the device flashes once and beeps. When the product is armed, the LED flashes every 3 seconds.

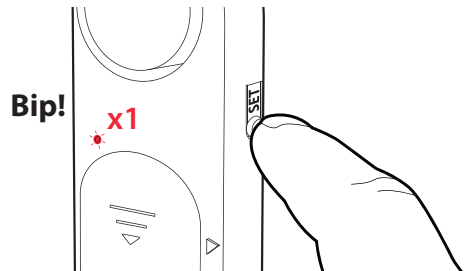

Briefly press the [SET] button to disarm the product. The device beeps twice and the red light flashes twice to indicate that it has been disarmed. The default mode is disarmed.

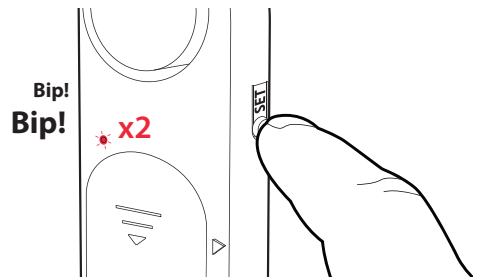

B - PRODUCT DESCRIPTION

When the product is armed: when the door is opened (the device is separated from the magnetic strip), the alarm is triggered immediately.

When the product is disarmed: when the door is open (the device is separated from the magnetic strip), the product does not react.

NOTE:

1) When the alarm is triggered, the red light flashes and rings for 30 seconds. After the 30 seconds, the mini-alarm stops ringing for 15 seconds. After the 15 seconds, the alarm restarts. This persists until the door is closed or the device is disarmed.

2) When the alarm is triggered and you close the door, the alarm will remain active for 30 seconds. After this period, the audible alarm will stop.

3) When the alarm is triggered and you press the [SET] button, this action will mute the device for 15 seconds. After the 15 seconds, the detector will ring again. If you close the door within this 15-second period, the alarm will stop.

3.3 ADDING/REMOVING REMOTE CONTROLS
(REMOTE CONTROL INCLUDED IN KIT REF: 100021,
REF: 100022 AND REF: 100032)

You can add remote controls (not included - sold in kit 100021, 100022 and 100032) to operate the mini alarm remotely.

Press and hold the [SET] button on the device; the red light turns on and beeps. The mini alarm enters the pairing phase. Press any button on the remote control.

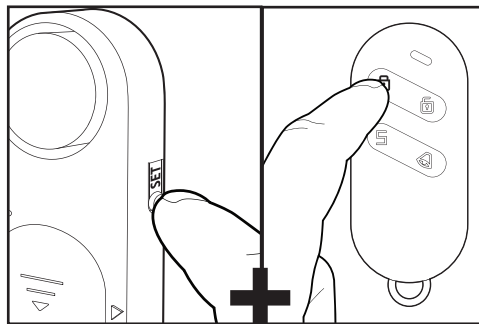

Pairing results

Case 1: If the detector beeps twice and the red light flashes twice, pairing has been successful.

Case 2: If the detector beeps and the red light

flashes just once, the remote control has already been paired.

Case 3: If the detector beeps three times and the red light flashes three times, the mini-alarm has reached the maximum number of remote controls it can store in memory.

Case 4: If the detector beeps four times and the red light flashes four times, all remote controls have been removed from the mini-alarm memory.

NOTE:

1) The device can be paired with a maximum of 30 remote controls.

2) To exit pairing mode, press the [SET] button or do nothing for 20 seconds.

3.4 - REMOVING ALL REMOTE CONTROLS

Push the switch down to "OFF". Press and hold the [SET] button and set the switch to the "ON" position. The mini-alarm slowly beeps ten times and the red light flashes, followed by five quick beeps and the red light flashing five times. Release the [SET] button; the detector returns to its factory settings, all remote controls are removed and the device switches to disarmed mode. The mini-alarm beeps twice and the red light flashes.

3.5 - LOW BATTERY REMINDER

When the device's batteries are low, the red light flashes every second. Replace the batteries in good time so that the normal operation of the device is not affected.

1 - INSTALLATION METHOD

First of all, clean the product's future surface thoroughly. Stick the detector firmly in place with double-sided adhesive tape. Please note the following: the device and the magnetic strip must be installed separately, i.e. the mini-alarm must be installed on the fixed frame of the door or window, and the magnetic strip must be installed on the door or window. There are small triangles on the magnet and on the mini-alarm. Please position these triangles opposite each other. The distance between the mini-alarm and the magnet must not exceed 10mm.

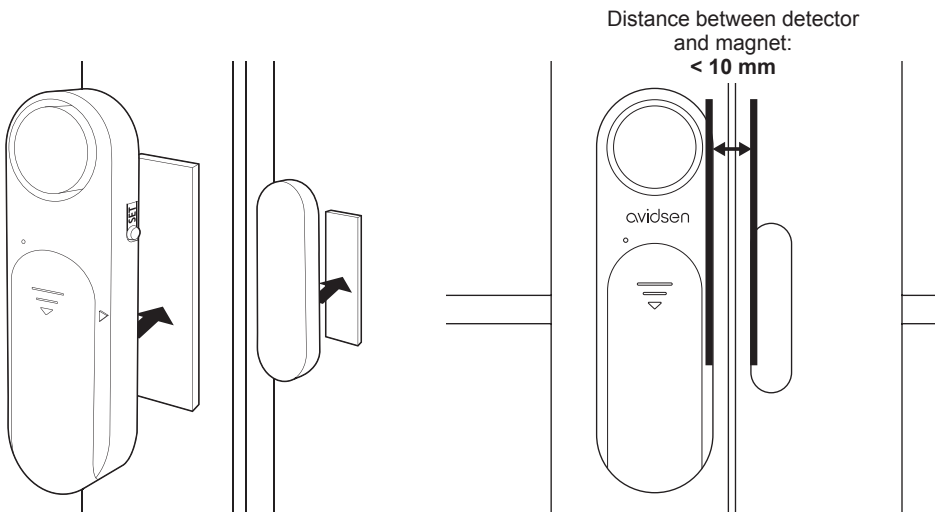
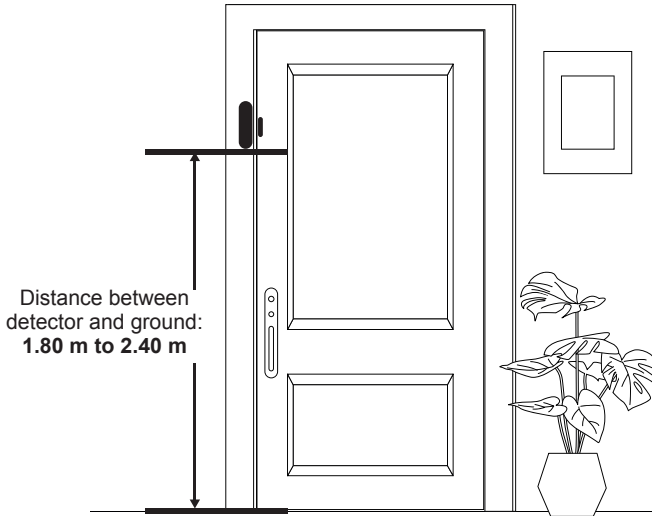

1 - TECHNICAL CHARACTERISTICS

DOOR OR WINDOW OPENING DETECTOR	
Operating voltage	3 V (2 AAA batteries)
Standby current	<150 uA
Operating current	< 80 mA
Wireless frequency	433.92 MHZ - max EIRP: 10 dBm
Alarm duration	30 s
Alarm volume	120 dB
Dimensions	Detector: 107 mm x 33 mm x 18 mm Magnet: 45 mmx12 mmx13 mm
Operating temperature	-10°C to 60°C

2 - WARRANTY

This product is guaranteed for parts and labour for 2 years from the date of purchase. Proof of purchase must be retained for the duration of the warranty period.

The warranty does not cover damage caused by negligence, knocks, or accidents. The parts of this product must not be opened or repaired by any persons not employed by Avidsen. The warranty will be void if the device is tampered with.

Avidsen undertakes to keep a stock of spare parts for this product throughout the contractual warranty period.

3 - EXTEND THE EXPERIENCE

Visit www.maisonics.com and our usual dealers for a full range of spare parts, compatible accessories and smart solutions to enhance your connected ecosystem. Give your installation a new dimension by improving its performance and longevity, while imagining a home that is ever more practical, safe and connected. Perfectly compatible products, designed to meet the demands of modern, efficient and sustainable living. With **Maisonics** and the **Avidsen** network, your installation can evolve without limit.

4 - EU DECLARATION OF CONFORMITY

Avidsen hereby declares that the equipment designated below:

AVIDSEN SMALL DOORGUARD reference 100023 complies with the RED 2014/53/EU directive and its conformity has been assessed pursuant to applicable standards:

EN 62479: 2010
EN IEC 62368-1:2020+A11:2020
ETSI EN 301 489-1 V2.2.3: 2019
ETSI EN 301 489-3 V2.3.2: 2023
ETSI EN 300 220-1 V3.1.1: 2017
ETSI EN 300 220-2 V3.2.1: 2018

Tours, 26/01/2026
Alexandre Chaverot, CEO





avidsen

Avidsen
19 avenue Marcel Dassault - ZAC des Deux Lions
37200 Tours - France